

HemiStar HS68

Projection Angle Chart																	
Display Type		Resolution			Panel Size (mm)			# Pixels Projected				Projection Angles (°)			Shift		
Dome Lens		H	V	Pixel Pitch (µm)	H	V	Diag.	H	V	@180°	Mpixel Count	H	V	TR Equiv.	H +/-%	V +/-%	V Angle +/-°
Partial Domes	1.2" 1080p	1920	1080	13.8	26.496	14.904	30.400	1442	1080	1442	0.92	180.0	130.2	—	0%	17%	24.9
	0.96" WUXGA	1920	1200	10.8	20.736	12.960	24.453	1843	1200	1843	1.13	180.0	112.7	—	0%	27%	33.6
	0.95" LCD WUXGA	1920	1200	10.65	20.448	12.780	24.113	1869	1200	1869	1.13	180.0	111.1	—	0%	28%	34.4
	0.94" HD1080	1920	1080	10.8	20.736	11.664	23.791	1843	1080	1843	0.92	180.0	101.3	—	0%	35%	39.4
	0.94" SXGA+	1400	1050	13.68	19.152	14.364	23.940	1400	1050	1455	0.87	171.7	125.3	—	2%	19%	27.4
	0.90" WQXGA	2560	1600	7.56	19.354	12.096	22.823	2560	1600	2633	2.01	173.9	105.1	—	1%	32%	37.5
	0.76" WUXGA	1920	1200	8.5	16.320	10.200	19.245	1920	1200	—	1.13	143.3	88.4	0.166	11%	48%	45.8
	0.67" WUXGA	1920	1200	7.56	14.515	9.072	17.117	1920	1200	—	1.13	126.6	78.6	0.251	19%	60%	50.7
	0.66" HD1080	1920	1080	7.56	14.515	8.165	16.654	1920	1080	—	0.92	126.6	70.7	0.251	19%	72%	54.7

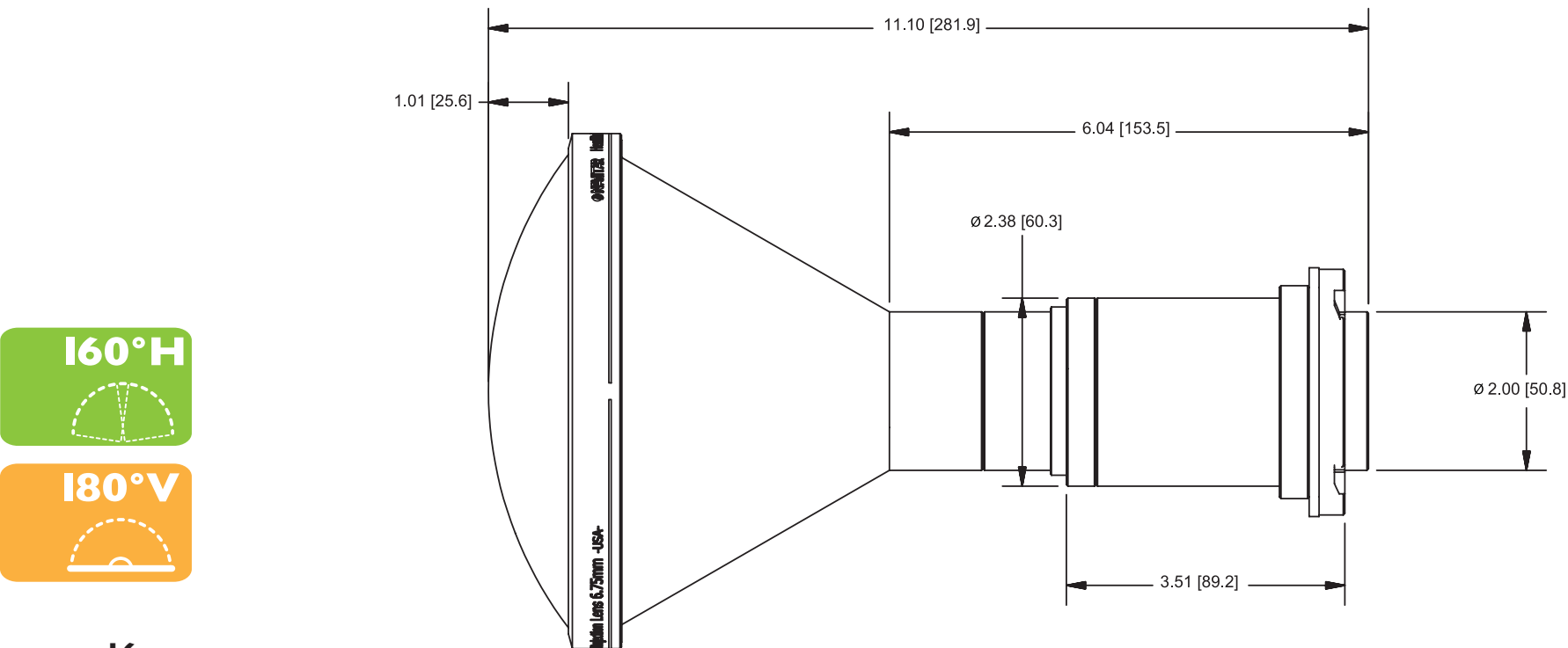

Panel Usage

Active Image on Projector Panel

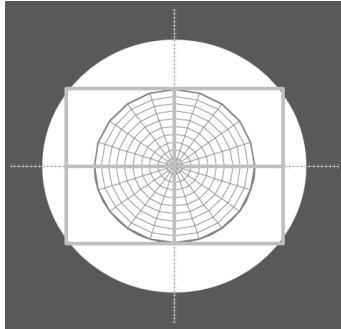

The illustration shows the active pixels used to project a hemisphere. A full hemisphere is projected as a circle of (active) pixels. This is a single channel example of the HS68 projecting a 1.3" XGA panel.

On-Screen Projection

Active Image on Screen

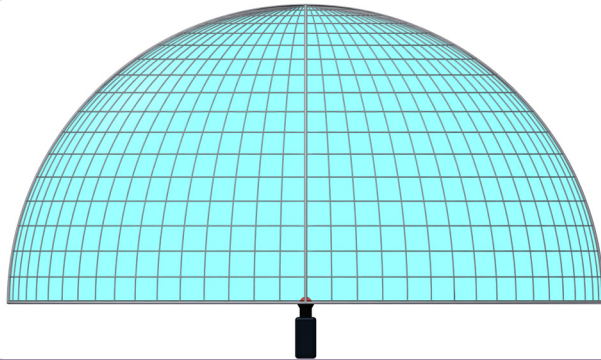

The illustration shows the projected image against a 5° azimuth-elevation grid. The projector is positioned at dome center and uniformly casts a hemispherical beam to the screen.

Lens Specifications

Focal Length	6.75mm	MTF Center	55% @ 46 lp/mm
Image Circle	19.882mm	MTF Edge	20% @ 46 lp/mm
Max Half-Angle	90°	Lateral Color R-G	< 7µm
F/#	F/3	Lateral Color B-G	< 9µm
Focus Range	800mm – Inf.	F-Theta Distortion	-5.7% Max
Transmittance	>82%	Relative Illum.	95%
Back Focus	Suitable for 0.95" single-chip DLP and 3LCD.		

HS68 - Model Numbers

Navitar Part #*	Projector	Resolution	Brightness ⁺
I-19306	Barco F32	SXGA+, 1080p, WUXGA	8,000
I-19306	Barco F35	1080p, WUXGA, WQXGA	7,500
I-19306	DP dVision 35	1080p, WUXGA, WQXGA	7,500
I-19306	Barco F90	WUXGA, WQXGA, 4K UHD	11,800
I-19004	Christie LX700/650	XGA	7,000
I-19004	Eiki LC X85	XGA	7,000

* Part numbers vary depending on projector manufacturer and model

+ Projector brightness is stated for reference only, it is not representative a maximum lens brightness rating.

